

SITE EXTENT (LEAST EXTENT AS PER PATTA) : 1300 SQ.M ✓
 PRIVATE PASSAGE AREA : 217 SQ.M ✓
 NO.OF.PLOTS : 8 Nos. ✓

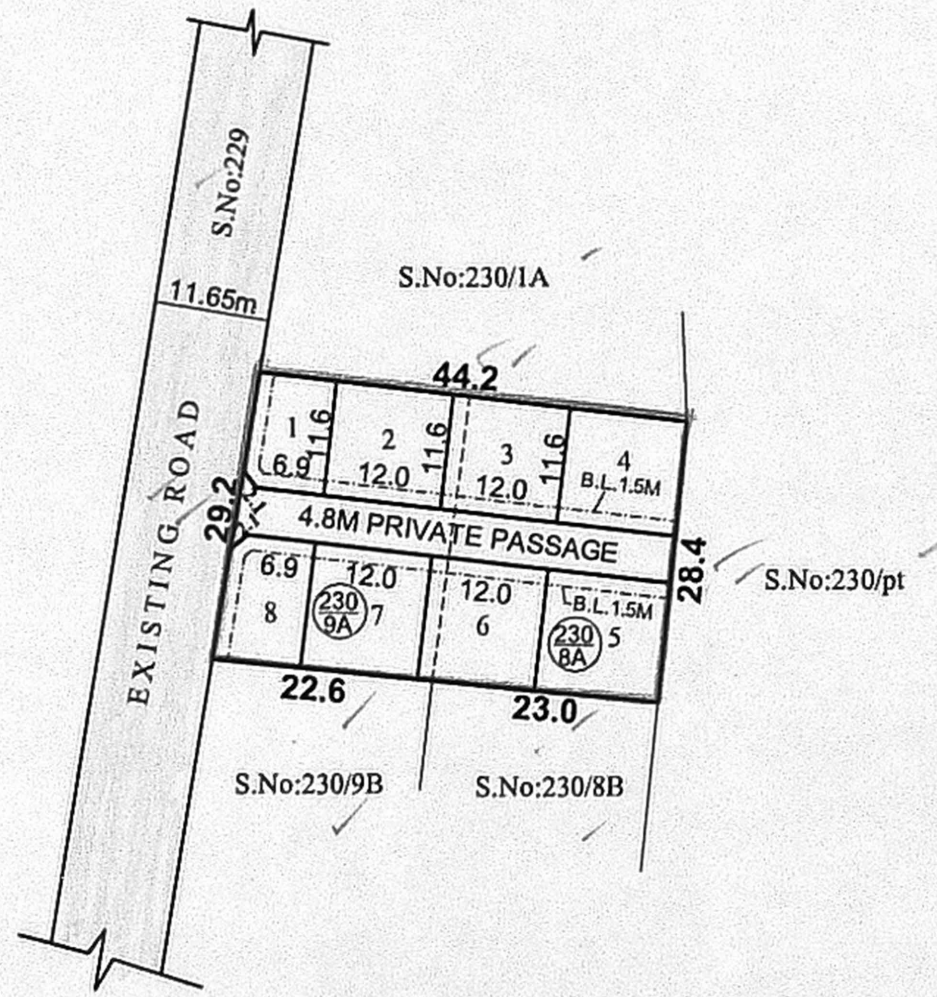

CONDITIONS :

DR RULE NO : 29 (11)

THE COST OF LAYING IMPROVEMENTS TO THE SYSTEMS IN RESPECT OF ROAD, WATER SUPPLY, SEWERAGE, DRAINAGE OR ELECTRIC POWER SUPPLY THAT MAY BE REQUIRED AS ASSESSED BY THE COMPETENT AUTHORITY SHALL BE BORNE BY THE APPLICANT.

LEGEND :

-  SITE BOUNDARY
-  EXISTING ROAD

CONDITION:-

THE SUB-DIVISION APPROVAL IS VALID SUBJECT TO OBTAINING SANCTION FROM THE LOCAL BODY CONCERNED

P.P.D NO 33
 L.O 2018

APPROVED

VIDE LETTER NO : L1/16711/2017

DATED : 30/05/2018

[Signature]
 30/05/2018
 FOR MEMBER SECRETARY
 CHENNAI METROPOLITAN
 DEVELOPMENT AUTHORITY

[Signature]
 P.A. III
 25/5/18
 PREPARED BY

[Signature]
 25/05/18
 P.A.II (A.A)

[Signature]
 25/05/2018
 A.P(S.A)

POONAMALLEE PANCHAYAT UNION

SUB - DIVISION OF HOUSE SITES IN S.Nos. 230/8A AND S.No.230/9A OF CHEMBARAMBAKKAM VILLAGE.

SCALE-1:800 (ALL MEASUREMENTS ARE IN METRE)

